



HUR - L - DE

The double-end CNC lathe is an efficient and high-precision machine. The workpiece clamped can turning the outer circle, end face and inner hole at the same time. The production efficiency is higher than the traditional process, and the coaxiality and accuracy of the processed parts are better. According to customer's request, loading and unloading auxiliary devices and automatic loading and unloading devices can be provided randomly. The clamping diameter ranges from $\phi 5\text{mm}$ - $\phi 250\text{mm}$, and the processing length ranges from 140mm-3200mm.



HUR - L – ODS

Opposite dual spindle CNC lathe is mainly used for turning short shaft and small disk parts. Through the automatic transfer between the two sequences of processing workpieces, the machine completes the



processing of the inner hole, outer circle and both ends of the part respectively. The machine can be equipped with manipulators, automatic loading and unloading and storage devices to complete the fully automated processing of parts. It is specially developed for the turning processing of short shaft and small plate parts.

Supporting Roller Machining Solution

Support roller is one of the important parts of "four wheels and one belt" in crawler bulldozers and hydraulic excavators. There are 4 specifications of bulldozer rollers and 7 specifications of excavator roller, according to our existing models, we are divided into 3 categories:



		ϕA	ϕB	ϕC	D	
1	JWZ135A	130	89	$39^{+0.2}_0$	68	3.1
2	JWZ154A	139	84	$44^{+0.2}_0$	68.3	3.72
3	JWZ175A	$163^{-0.5}_{-1}$	105.5	$51^{+0.2}_0$	$92.5^{+0.3}_0$	7.02
4	JWZ190A	$188^{-0.5}_{-1}$	126.5	$64^{+0.2}_0$	$117^{0}_{-0.3}$	10.4
5	JWZ216A	$212^{-0.3}_{-0.8}$	141.5	$73^{+0.2}_0$	$124^{0}_{+0.5}$	15.4
6	JWZ228C	250	72	$89.5^{+0.5}_0$	143 ± 0.3	25.6
7	JWZ260	340	191	116 ± 0.3	$189^{+0.5}_0$	69.7

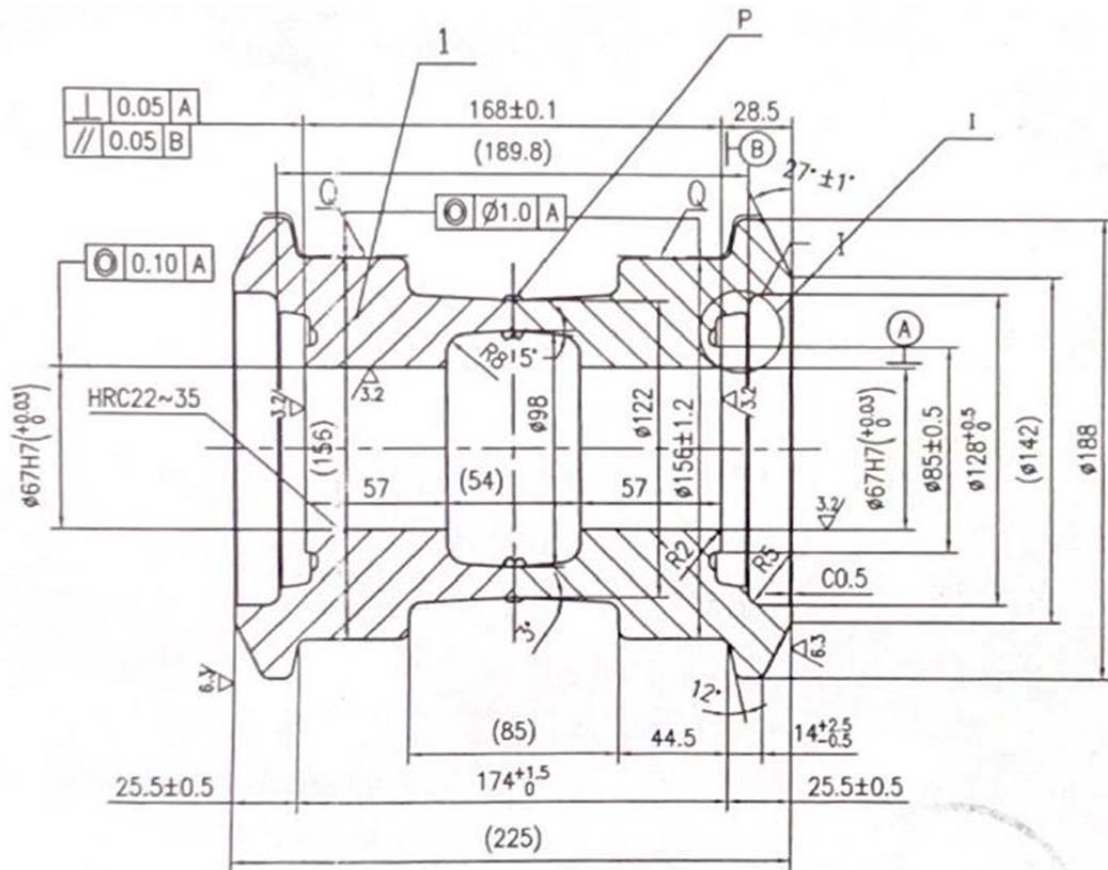

- The machine adopts 450 inclined bed layout, which has good rigidity and convenient chip removal.
- The spindle box integrates the three components of the spindle system, fixture and clamping cylinder, with compact structure and reliable work. The fixture is hydraulically clamped. The clamping diameter of the clamp is divided into two blocks.
- The clamp is of collet type. Adjusting claws are installed in the elastic chuck to replace the processing parts and change the clamping diameter. You only need to replace the adjusting claws, which is quick and convenient.
- Multiple boring tools are required according to the machined parts. To avoid interference of the tools, the turret is customized, and the rotating diameter of the cutter head is large. In order to make the turret more rigid, the center height of the turret is 125mm.
- The machine is equipped with a dual-channel control system, and the two tool rests can be linked with the spindle at the same time or separately to complete simultaneous or sequential processing of both ends of the part.
- In order to meet the different requirements of different customers, this machine tool can be equipped with left/right console for customers to choose.
- As for loading and unloading, currently it is manual loading and unloading. Considering the heavy weight of the supporting wheels, truss-type or joint-type automatic loading and unloading devices can be equipped, subject to negotiation with the buyer.

Specification

Contact information

Modiin Technology GmbH (modiin-technology.com)

Steinklütstraße, 12, St. Gilgen, 5340, Austria

© 2015-2022 Modiin Technology GmbH. All Rights Reserved.



Item	Name		Unit	Specifications	
Processing range	Maximum turning diameter of bed		mm	Φ550	Φ600
	Maximum rotating diameter of sliding body			Φ350	
	Maximum clamping diameter			Φ175	Φ250
	Maximum processing length			Shaft1000; Tube: 400	
	Spindle speed		r/min	1000	600
Headstock	Width of headstock		mm	175	280
	Spindle clamping specifications			Φ130、139、166	Φ188、212、250
	Spindle hole diameter			Φ175	Φ250
	Height from spindle center to ground			1150	
	Feed	Travel		X1/X2	150/150
Z1/Z2			480/600		
	Working forward	X/Z	mm/r	0.001~6	
	Fast forward	X/Z	m/min	16	
Tool post	Drive way			Slewing servo, locking hydraulic	
	Number of tools		Station	8	
	External knife square size		mm	□32×32	
	Diameter of boring bar			Φ50	
Machine size (length×width×height)			mm	4920×1860 (1910) ×1900	
Machine weight	Net weight		Kg	6700	
	Gross weight			7700	